

JQC-3FF

SUBMINIATURE HIGH POWER RELAY



File No.:R50034671



File No.:E133481



File No.:CQC02001001953

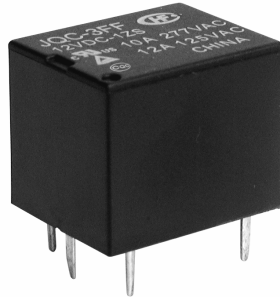

Features

- * Extremely low cost
- * SPST-NO & SPDT configuration
- * Subminiature, standard PCB layout
- * Sealed IP67 and Flux proof types available

CONTACT DATA

Contact Arrangement	1A	1C
Initial Contact Resistance Max.	100mΩ (at 1A 6VDC)	
Contact Material	Silver Alloy	
Contact Rating (Res. Load)	10A 277VAC	7A 250VDC 10A 277VAC
Max. switching voltage	277VAC/30VDC	
Max. switching current	15A	10A
Max. switching power	2770VA 210W	
Mechanical life	1 x 10 ⁷ OPS	
Electrical life	1 x 10 ⁵ OPS	

CHARACTERISTICS

Initial Insulation Resistance	100MΩ ,500VDC	
Dielectric Strength	Between coil and contacts	1500VAC, 1min
	Between open contacts	750VAC, 1min
Operate time (at nomi. Volt.)	Max. 10ms	
Release time (at nomi. Volt.)	Max. 5ms	
Temperature rise (at nomi. Volt.)	Max. 60°C	
Shock Resistance	Functional	98 m/s ² (10g)
	Destructive	980 m/s ² (100g)
Vibration Resistance	1.5mm, 10 to 55Hz	
Humidity	35% to 85%RH	
Ambient temperature	-40°C to +85°C	
Termination	PCB	
Unit weight	Approx. 10g	
Construction	Sealed IP67 & Flux proof	

COIL

Coil power	0.36W*48VDC : 0.51W*
------------	----------------------

COIL DATA

Nominal Voltage VDC	Pick-up Voltage VDC	Drop-out Voltage VDC	Max. allowable Voltage VDC(at 25°C)	Coil Resistance Ω
5	3.80	0.5	6.5	70 ± 10%
6	4.50	0.6	7.8	100 ± 10%
9	6.80	0.9	11.7	225 ± 10%
12	9.00	1.2	15.6	400 ± 10%
18	13.5	1.8	23.4	900 ± 10%
24	18.0	2.4	31.2	1600 ± 10%
48	36.0	4.8	62.4	4500 ± 10%

SAFETY APPROVAL RATINGS

Approval	Configuration	Rating
UL	1 Form C	10A 277 VAC 10A 120VAC 1/2 HP 125/250VAC
	1 Form A	10A 277VAC TV-5 120VAC 15A 125VAC 120VAC 125VAC 1/2hp,125VAC
TÜV	1 Form C	8A 250VAC 12A 125VAC cos phi=1 5A 250VAC cos phi=1
	1 Form A	10A 277VAC 12A 125VAC cos phi=1 5A 250VAC cos phi=1



HONGFA RELAY
ISO9001*ISO/TS16949 *ISO14001 CERTIFIED

VERSION: EN02-20040601

ORDERING INFORMATION

JQC-3FF / 012 1H S T F

Type

Coil voltage 5, 6, 9, 12, 18, 24, 48VDC

Contact arrangement 1H:1 Form A (SPST-NO) 1Z:1 Form C (SPDT)

Structure S: Sealed IP67 Nil: Flux proof

Contact Material T: AgSnO₂ Nil: AgCdo

Insulation System F: Class F 155°C Nil: Class B 130°C

OUTLINE DIMENSIONS, WIRING DIAGRAM AND PC BOARD LAYOUT

Outline Dimensions

PCB layout

Wiring Diagram

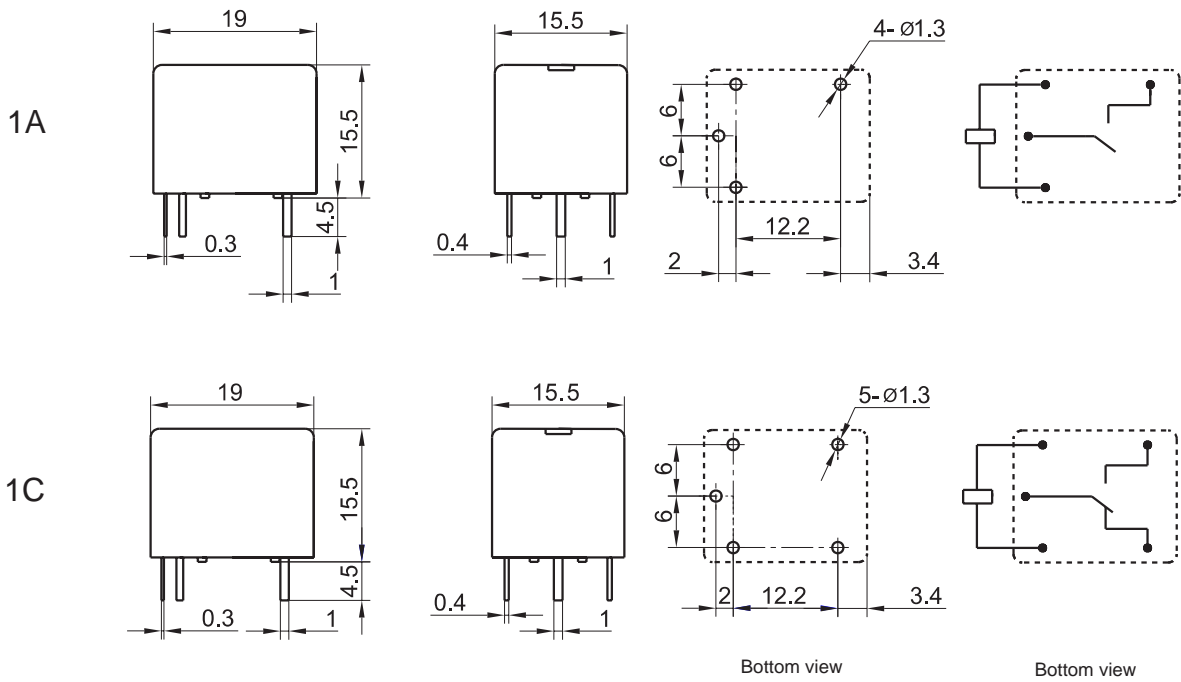

CHARACTERISTICS CURVE

MAXIMUM SWITCHING POWER

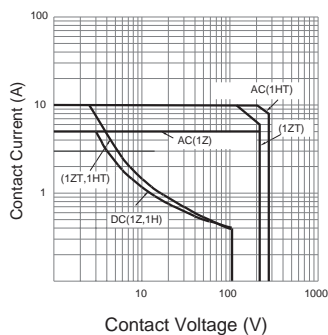

LIFE CURVE

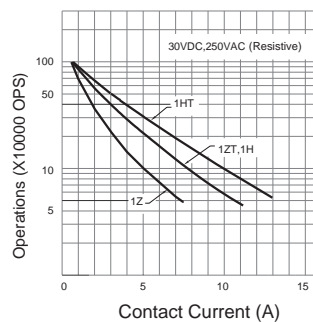

COIL TEMPERATURE RISE

